



PGCPS . **ENGAGE . DESIGN . BUILD . COMMUNICATE** . PGCPS



KENMOOR MIDDLE SCHOOL

CONSTRUCTION UPDATE MEETING | OCTOBER 11th, 6:00 PM



PRINCE GEORGE'S COUNTY
EDUCATION & COMMUNITY PARTNERS

SERVICIOS DE INTERPRETACIÓN

INTERPRETING SERVICES

La interpretación simultánea
está disponible en español.
*Simultaneous interpretation is
available in Spanish.*

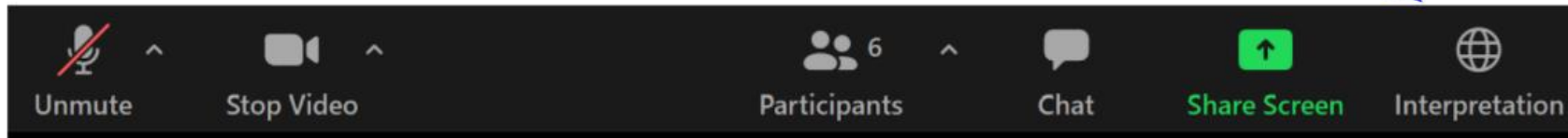

SERVICIOS DE INTERPRETACIÓN

INTERPRETING SERVICES

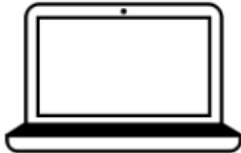

On a computer-- At the bottom of the screen will be an interpretation globe. Click that globe and then select *Spanish*.

En una computadora-- En la parte baja de la pantalla habrá un globo de interpretación. Haga clic en ese globo y seleccione "Spanish."



On a mobile device-- At the bottom of the screen, tap the ellipses icon on the bottom right (...).

- Tap *Language Interpretation*.
- Tap *Spanish*.

En un dispositivo móvil-- En la parte baja de la pantalla, toca el icono de elipses en la parte baja derecha (...).

- Toque *Language Interpretation*.
- Toque *Spanish*.



We value your input.

- Please type your questions/comments in the Q&A area of Zoom.
- Questions and answers from this town hall will be posted on pgcpsblueprintschools.com.

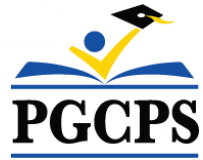

Our Commitment

PGCPS is moving swiftly to deliver safe, state-of-the-art, and sustainable learning environments for our students, teachers, and communities.

Through a three-pronged approach, traditional Capital Improvement, Staged Renovations, and the nation's first Public School P3 Design-Build-Maintain approach, otherwise known as the Blueprint Schools Program, we're on track to deliver over 25 modernized school facilities in just 10 years.



Agenda

- Team Introductions
- Project Scope
- Construction Overview
- Q&A

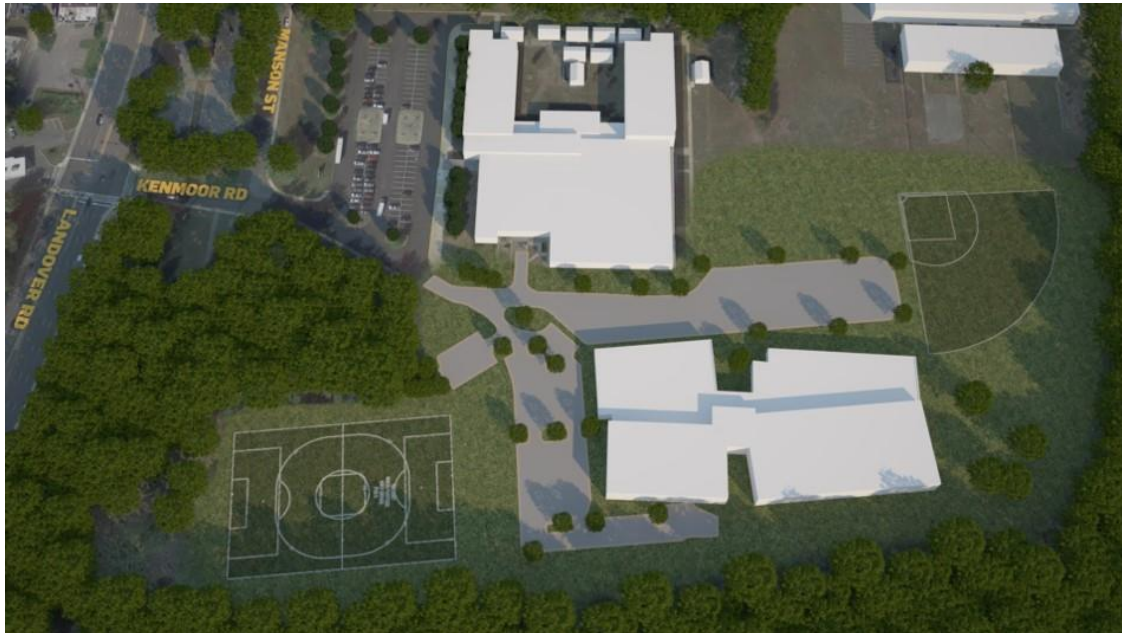



Team Introductions

- **Jason Washington**, Director, Blueprint Schools
- **Brandey McDonald**, Project Director, Fengate
- **Mike Ricketts**, Senior Project Executive, Gilbane
- **Brian Malanchuk**, Senior Project Executive, Gilbane
- **Christian Broyles**, Project Executive, Gilbane
- **Santiago Mejia**, Project Manager, Gilbane
- **Amber Brown**, Project Manager, B&D



Project Scope

Project Status: Construction

Square Footage: 144,800 SF

Occupancy: 1,200

Address: 2501 Kenmoor Drive,
Landover, MD 20785

Construction Overview

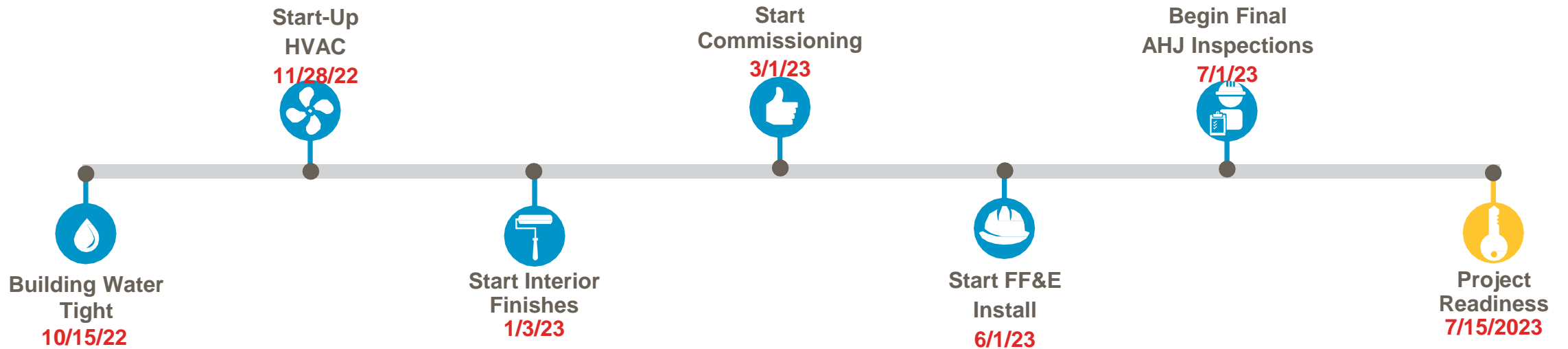

Construction Overview

Completed Work	Work in Progress	Next Steps
Exterior wall panel installation	Interior stud wall framing and one-sided drywall partitions	Elevator equipment delivery and installation
TPO roofing installation	Interior MEPF overhead and in-wall rough-ins	Curb, gutter, and base coat asphalt installation
Primary and secondary steel	Main mechanical room and electrical room rough-ins	Parking lot grading
Installation of exterior windows	Interior door frame installation	
Interior CMU block wall construction	Installation of underground site utilities	
Electrical switchgear installation		

Construction Overview



Construction Overview



Construction Overview



Construction Overview



Upcoming Work

Gilbane will be taking over the playground/field in order to begin installation of the basketball court. The work will begin in November 2022 with the installation of the Limit of Disturbance Fencing. Other work will include:

- Underground Site Utilities
- Site Grading
- Basketball Court Surface Install (By End of Year)

Questions & Answers

Please note, we will only be addressing construction updates and logistics questions. All programming or operational questions will be addressed at a later date.

Thank You!

To submit additional questions and to view today's presentation, visit www.pgcpsblueprintschools.com